

M02 Torque Wrench

The M02 Torque Wrenches are used for accurate measurements of the bolt or nut wrenching torques. These torque wrenches are bi-directional that is why both tightening and break-away torques can be measured. They operate on the strain gauge principle. The built-in amplifier provides a high level of the output signal.

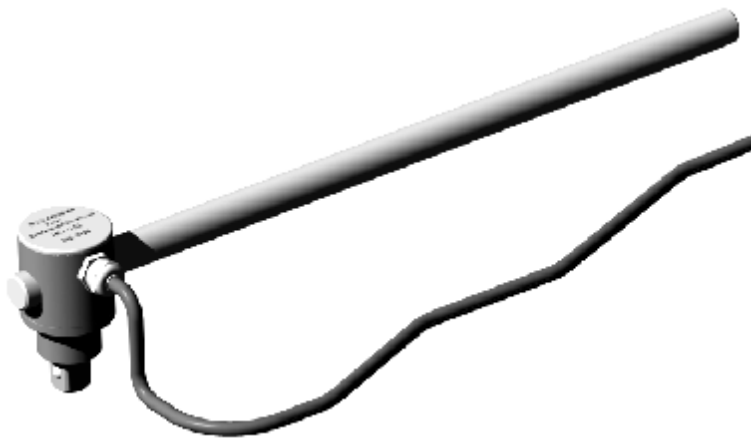

Special features:

- Operating on the strain gauge principle
- Built-in amplifier
- Insensitive to lateral and axial forces and to bending moment
- Accuracy class: 0.2
- Torque output signal: $\pm 2V$

Dimensions, mm

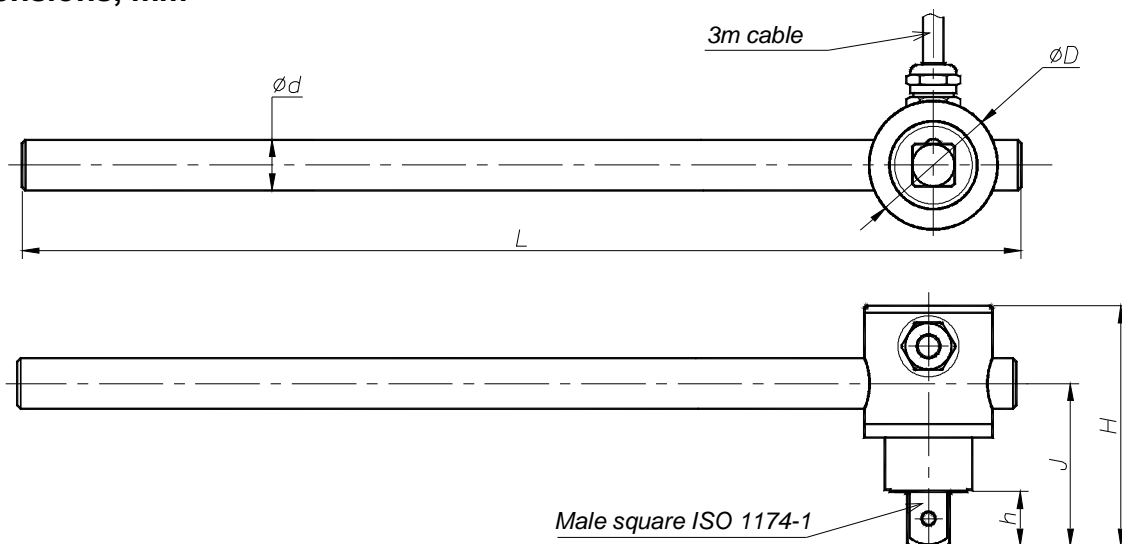

Type	Nominal torque	Square	ϕD	ϕd	L	H	h	J
M02-20	20Nm	3/8"	30	10	200	60	11	40
M02-50	50Nm	3/8"	32	12	250	60	11	41
M02-100	100Nm	1/2"	38	15	400	70	15	49
M02-200k	200Nm	1/2"	44	20	500	76	15	52
M02-500	500Nm	3/4"	52	26	500+500	91	23	65
M02-1k	1000Nm	1"	62	30	500+600	104	28	75

Technical data

1. Electrical and metrology parameters

Nominal output signal with positive (right-hand) nominal torque	V	+2
Nominal output signal with negative (left-hand) nominal torque	V	-2
Output signal at torque = zero	V	0
Deviation of the actual output signal at the nominal torque from the nominal value	%	±0.2
Accuracy class		0.2
Temperature effect on the output signal, related to the actual output value	%/10°C	±0.1
Temperature effect on the zero signal, related to the nominal output value	%/10°C	±0.1
Linearity deviation including hysteresis, related to the nominal output value	%	±0.1
Limit load resistance	kΩ	10
Nominal excitation voltage	V (DC)	5...12
Current consumption	mA	< 20

2. Parameters of resistance to environment and mechanical exposures

Nominal temperature range	° C	0...+60
Storage temperature range	° C	-10...+70
Vibration resistance:		
Frequency range	Hz	10...55
Duration	h	1
Acceleration	m/s ²	40
Impact resistance:		
Number of impacts	n	1000
Duration	ms	10
Acceleration	m/s ²	400
Degree of protection		IP 40

3. Permissible load limits and mechanical values

Nominal torque M _N	Nm	20	50	100	200	500	1000
Limit torque, related to M _N	%	150					
Axial limit force on the rotor	kN	0.4	0.8	1	2	3	5
Lateral limit force on the rotor	N	0.2	0.4	0.8	1.6	2.5	5.0
Bending limit moment on the rotor	Nm	10	20	50	100	200	400
Weight	kg	0.4	0.5	0.8	1.7	3.7	6.8

In addition to the torque wrench, there is the T02 measuring unit to supply the operating voltage and indicate torque measured value.

Scope of delivery

M02 Torque Wrench	1
Connecting cable M02.10, 3m length	1
Operating manual	1

Accessories (to be ordered separately)

T02 Measuring Unit	1
--------------------	---

Modifications reserved.

TILKOM can produce torque transducers in accordance with Customized specific requirements.

TILKOM Ltd

Post code, 220116, box 236, Minsk, Republic of Belarus

Phone/fax (+375-17) 271-34-27, ph. 284-01-76. E-mail: info@tilkom.com www.tilkom.com